

This drawing is copyright to Salford City Council. It shall not be used without permission for any purpose. Reproduction is only permitted by prior arrangement. Do not scale from this drawing. All dimensions are in millimetres unless otherwise stated.  
**COMMERCIAL IN CONFIDENCE**

© Crown copyright and database rights 2021 Ordnance Survey 100019737

**SAFETY, HEALTH AND ENVIRONMENTAL INFORMATION**

In addition to the hazards/risks normally associated with the types of work detailed on this drawing, note the following:

	SHE001	Underground High Voltage Cables
	SHE002	Existing trees
	SHE003	Pedestrian Route Access
	SHE004	St Paul's Peel Primary School
	SHE005	Overhead cables
	SHE006	Peel Park Entrance

It is assumed that all works will be carried out by a competent contractor working, where appropriate, to an approved method statement

- Notes:
1. This drawing is to be read in conjunction with Works Specification and the drawings listed in the Works Information. Any discrepancies, errors or omissions are to be brought to the attention of the supervising Engineer.
  2. All dimensions are to be checked before commencement of work on site.
  3. Traffic signs & road markings to be in accordance with TSRGD 2016.

Key:

	Proposed carriageway resurfacing
	Proposed high friction surfacing (HFS)
	Proposed footway resurfacing
	Proposed red tactile paving
	Proposed buff tactile paving
	Proposed hazard warning paving
	Proposed bus platform
	Existing grass verge to be extended
	Scheme Extents
	Proposed kerb line

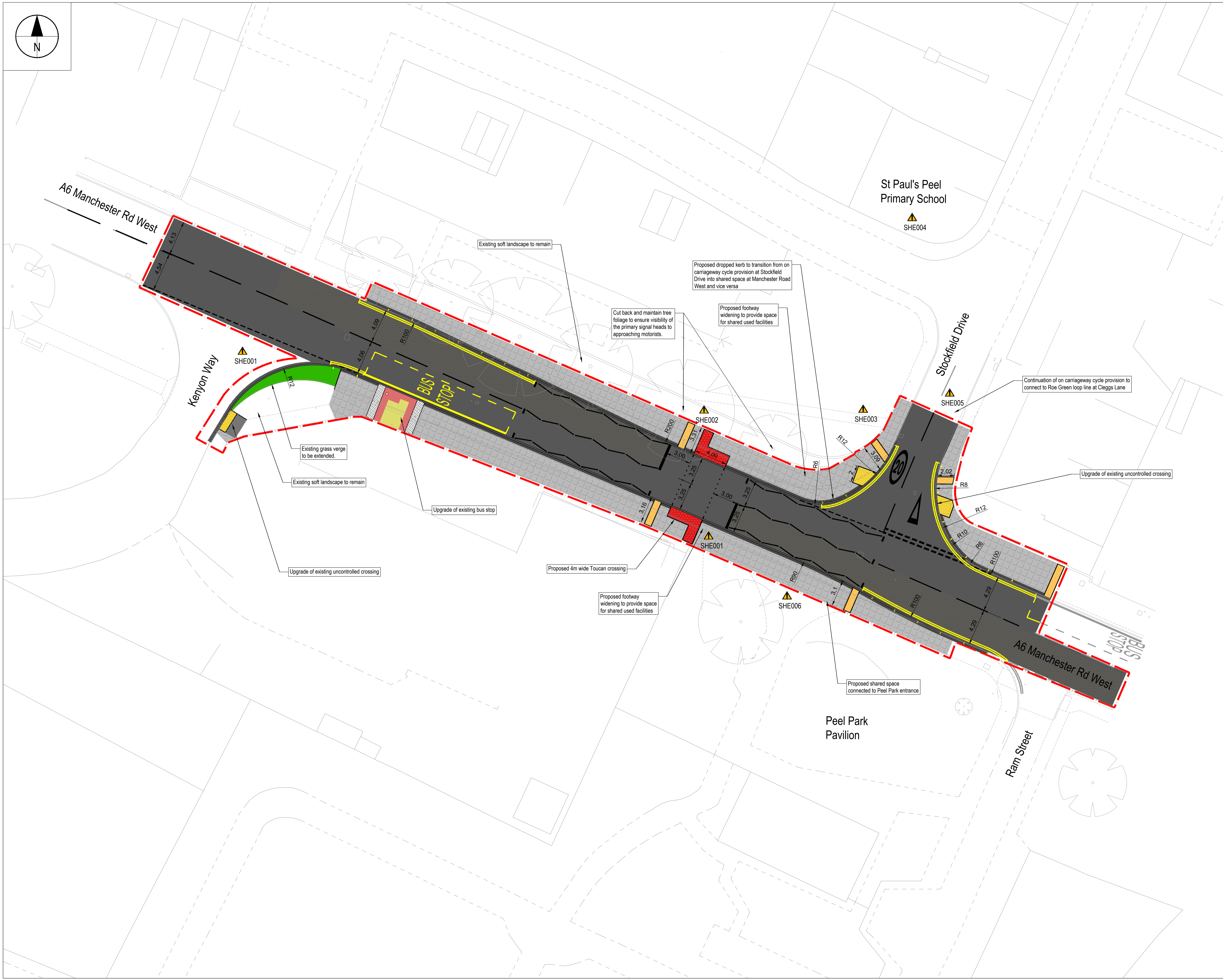

P01	Issued For Tender	07/10/2022	ROP	NJS	SRH
REV	DESCRIPTION	DATE	DRN	CHK	APP

**Salford City Council**

SALFORD CITY COUNCIL, CIVIC CENTRE, CHORLEY ROAD, SWINTON, MANCHESTER, M27 5AW. T 0161 775 4600

CLIENT  
 Salford City Council

PROJECT  
 Manchester Road West  
 Proposed Crossing Facility

DRAWING  
 General Arrangement

PURPOSE OF ISSUE  
 D2 - FOR TENDER

DRAWN	CHECKED	APPROVED	SCALE @ A1	DATE
ROP	NJS	SRH	1:200	07/10/2022

PROJECT REF.	REVISION
010557	P01

DRAWING NUMBER  
 010557-SCC-HGN-XX-DR-C-0001  
[www.salford.gov.uk](http://www.salford.gov.uk)